



BLADE®

TG-BL2F7048

BEFORE INSTALLATION

READ INSTRUCTIONS CAREFULLY BEFORE STARTING INSTALLATION. REMOVE CONTENTS FROM BOX AND VERIFY ALL PARTS ARE PRESENT. ASSISTANCE IS RECOMMENDED. FAILURE TO IDENTIFY DAMAGE BEFORE INSTALLATION COULD LEAD TO A REJECTION OF ANY CLAIM. IF ANY DAMAGE FOUND, PLEASE TAKE A PICTURE FOR THE CLAIM PURPOSE. PLEASE ALSO SEND THE PICTURES, ORDER NUMBER, AND DETAILS OF THE ISSUE TO SUPPORT@TYGERAUTO.COM.

Torque Value

Fastener Size	Class 8.8 Tightening Torque (ft-lbs)	Class 10.9 Tightening Torque (ft-lbs)
6mm	6-7	6-7
8mm	15-16	22-23
10mm	31-32	44-45
12mm	54-55	78-79
14mm	87-88	125-126

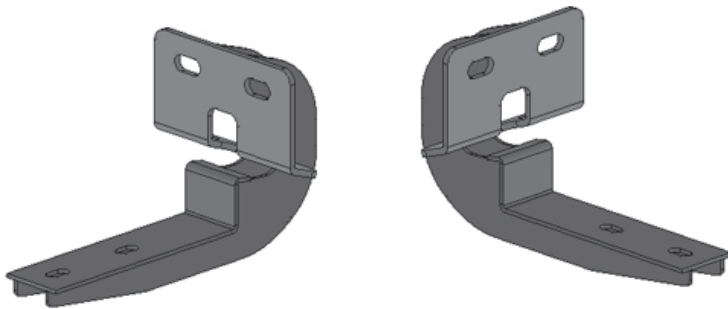

(4) Mounting Brackets

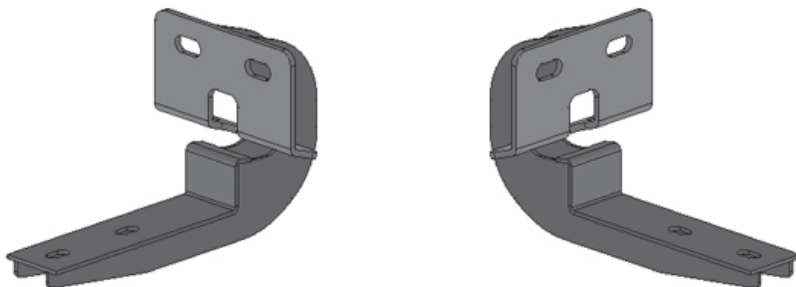

Parts List

- x2 78" TYGER Blade Running Boards
- x4 Mounting Brackets
- x4 8-1.25mm Double Bolt Plates
- x8 8-1.25mm Clip-On Nuts
- x8 8-1.25mm x 30mm Hex Bolts
- x8 8-1.25mm x 25mm Hex Bolts
- x8 8mm x 28mm x 3mm Large Flat Washers
- x24 8mm x 24mm x 2mm Flat Washers
- x16 8mm Lock Washers
- x8 8-1.25mm Hex Nuts
- x8 8-1.25mm Nylon Lock Nuts

Tool Needed:

13mm Socket
13mm Wrench



STEP 1

Starting on the Passenger side front of the vehicle, locate the (2) holes in the bottom of the body panel, (pinch weld), toward the front tire, (Fig 1). Next locate the rectangular opening and (2) small holes in the inner body panel directly above the holes in the pinch weld, (Figs 1-2).

NOTE: The holes in the inner panel may be covered with sealing tape or insulation.

STEP 2

Slide (1) 8mm Clip Nut into the rectangular opening with the nut towards the inside. Line up the threaded nut on the clip with the round hole, (Fig 3). Repeat to install the 2nd 8mm Clip Nut in remaining hole location

Locate holes through pinch weld (arrows) to determine mounting locations

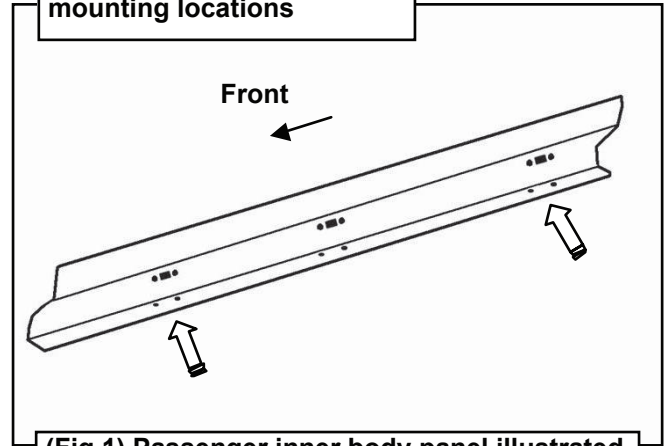

(Fig 1) Passenger inner body panel illustrated

NOTE: Depending on model and year, the brake cable may be run on the outside of the Bracket.

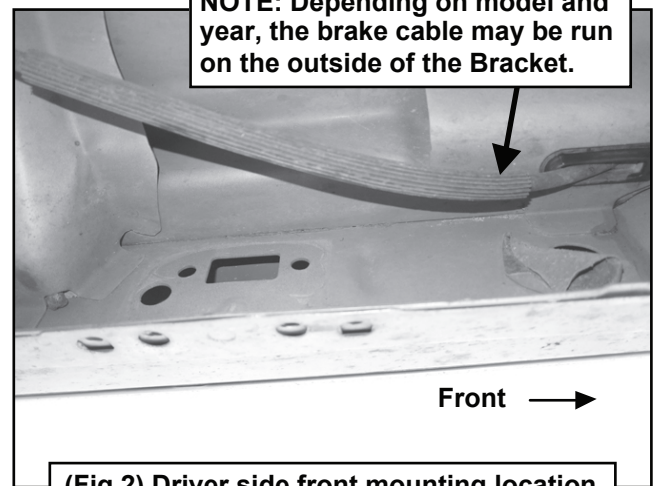

(Fig 2) Driver side front mounting location

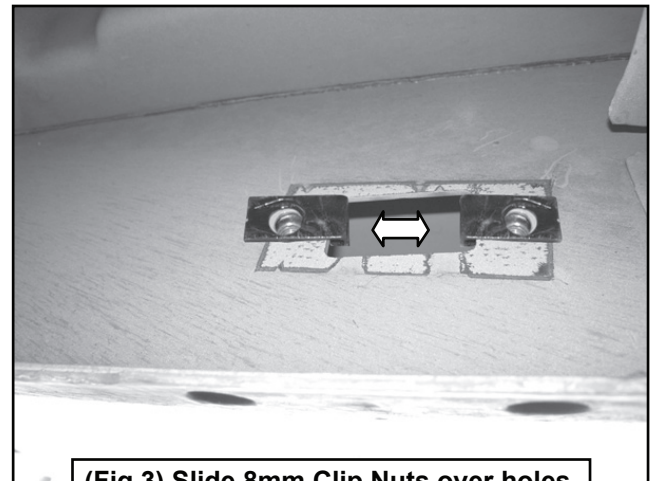

(Fig 3) Slide 8mm Clip Nuts over holes



STEP 3

Select (1) Mounting Bracket. Attach the Bracket to the (2) Clip Nuts with the included (2) 8mm x 30mm Hex Bolts, (2) 8mm Lock Washers and (2) 8mm x 28mm Large Flat Washers, (Figs 4 & 6). Do not tighten hardware at this time.

NOTE: On the Driver/left front side of the vehicle the run the brake cable on the outside of the Bracket.

STEP 4

Align the bottom holes in the Bracket with the (2) holes in the pinch weld. Attach the Bracket to the pinch weld using the included (2) 8mm x 25mm Hex Bolts, (4) 8mm x 24mm STD Flat Washers, (2) 8mm Lock Washers and (2) 8mm Hex Nuts, (Figs 5-6).

NOTE: Insert the bolts up from the bottom of the pinch weld and through the Bracket.

(2) 8mm x 30mm Hex Bolts
(2) 8mm Lock Washers
(2) 8mm x 28mm Large Flat Washers

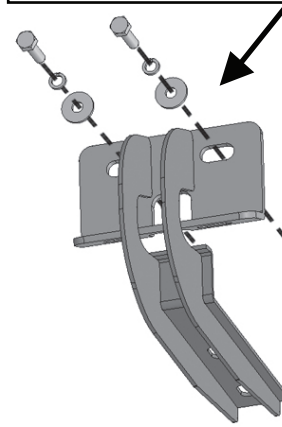

(Fig 4) Mounting Bracket attached to body panel

(2) 8mm x 25mm Hex Bolts
(4) 8mm STD Flat Washers
(2) 8mm Lock Washers
(2) 8mm Hex Nuts

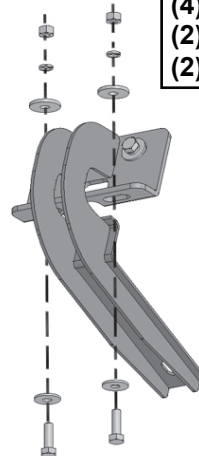

(Fig 5) Mounting Bracket attached to pinch weld

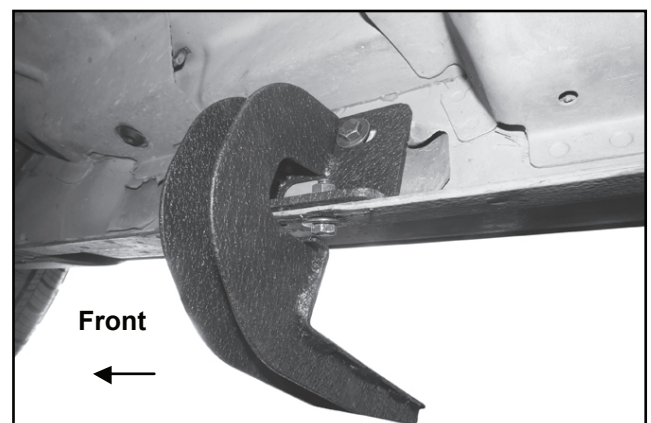

(Fig 6) Passenger front side Bracket installed



TYGER®

STEP 5

Continue along the cab to the rear mounting location and locate the last (2) mounting holes in the pinch weld at the back of the cab, (Fig 1). Repeat Steps 1-4 for Bracket installation, (Fig 7).

STEP 6

Select (1) Running Board and (3) 8mm Double Bolt Plates. Place the Running Board on top of the (3) Brackets. Insert the Bolt Plates into the channel in the bottom of the Running Board closest to the Brackets, (Fig 8). Lift the Running Board up and guide the studs down through the Brackets.

STEP 7

Attach the Running Board to the Brackets with (4) 8mm x 24mm Flat Washers and (4) 8mm Nylon Lock Nuts, (Fig 9). Do not tighten hardware at this time.

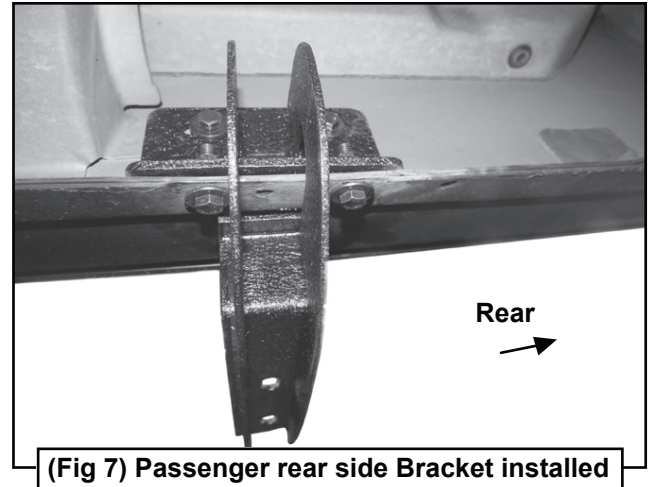

(Fig 7) Passenger rear side Bracket installed

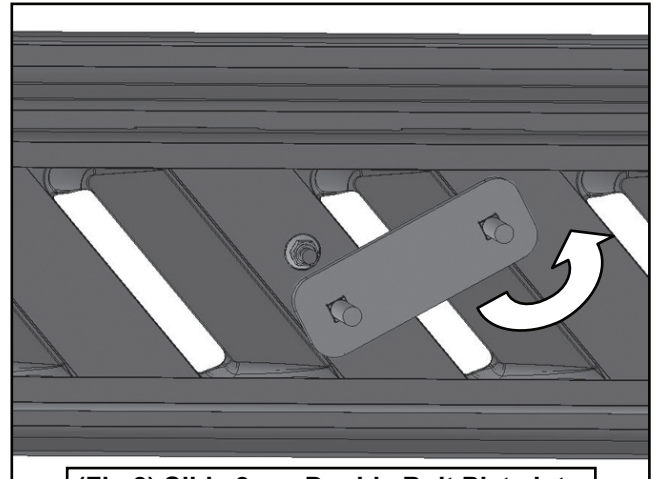

(Fig 8) Slide 8mm Double Bolt Plate into channel on bottom of Running Board

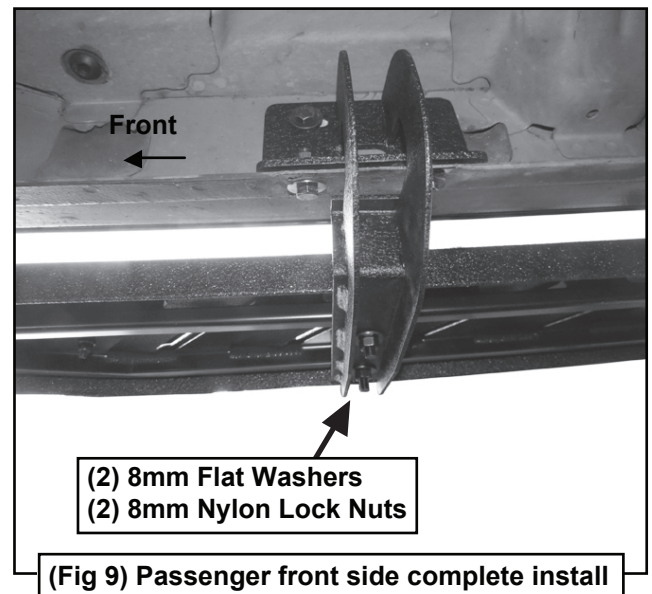

(Fig 9) Passenger front side complete install



TYGER®

STEP 8

Level and adjust the Running Board and tighten all hardware.

STEP 9

Repeat Steps 1-8 for Driver/left side Running Board Installation

STEP 10

Do periodic inspections to the installation to make sure that all hardware is secure and tight.

