

S5237

2021-UP FORD BRONCO, 2-DOOR/4-DOOR,
2.3L/2.7L ECOBOOST, CAT-BACK, 3.0"
SINGLE HIGH CLEARANCE REAR EXIT

MBRP®

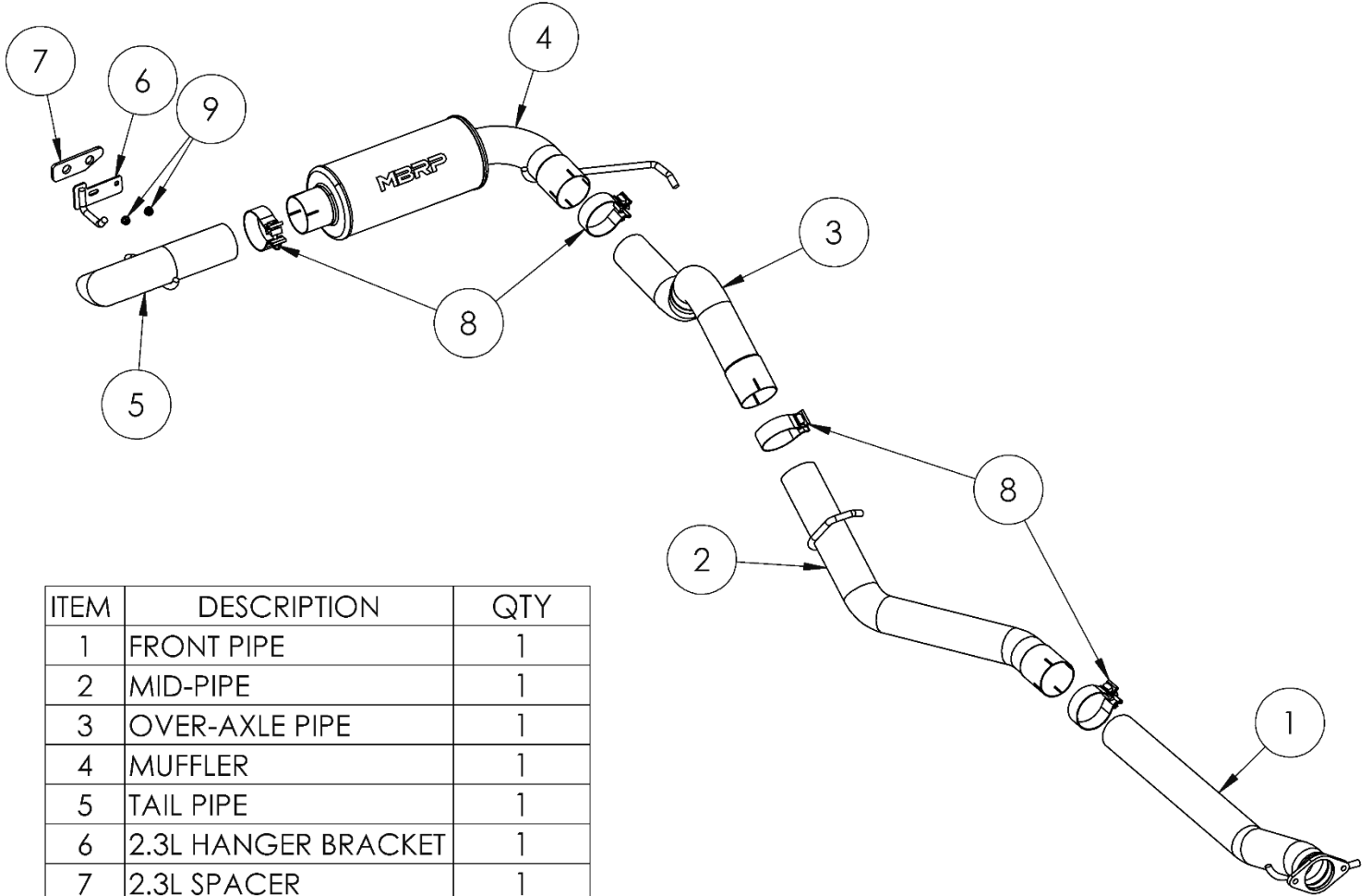

ITEM	DESCRIPTION	QTY
1	FRONT PIPE	1
2	MID-PIPE	1
3	OVER-AXLE PIPE	1
4	MUFFLER	1
5	TAIL PIPE	1
6	2.3L HANGER BRACKET	1
7	2.3L SPACER	1
8	3.0" CLAMP	4
9	M8 FLANGE NUT	2

PLEASE READ BEFORE STARTING INSTALLATION

While MBRP has made every effort to ensure that all components of this system are of superior quality and properly packaged, it is the installer's responsibility to ensure the following before removal of the factory exhaust:

- that ALL components shown above are present.
- that ALL mating components fit together.
- that there are no damaged components.
- that the system you have purchased is appropriate for your vehicle year, model and configuration.
- that the system will not interfere with any modifications previously installed or planned.
- that you have read and understand these instructions.

If you have any questions or are uncertain about any aspect of the installation of this system to your vehicle please contact your dealer before commencing installation.

MBRP

Removal of Stock System

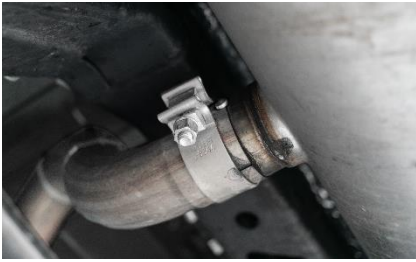

Figure 1

1. Apply a penetrating lubricant liberally to all hangers and rubber isolators.
2. Loosen the factory band clamp located before the muffler, remove the muffler.

Refer to Figure 1.

3. Remove hanger bracket and front flange hardware. Retain the hardware for installation. Remove the pipe from the vehicle.

Refer to Figure 2.

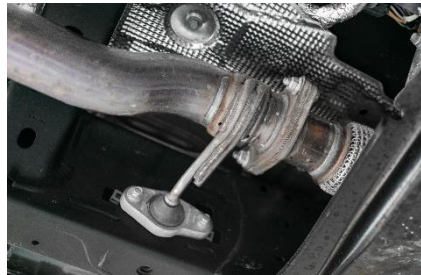

Figure 2

Installation of MBRP Performance Exhaust:

1. For 4-Door models skip to step 2. For 2-Door models trim the **Front Pipe**.

Refer to Figure 3.



Figure 4

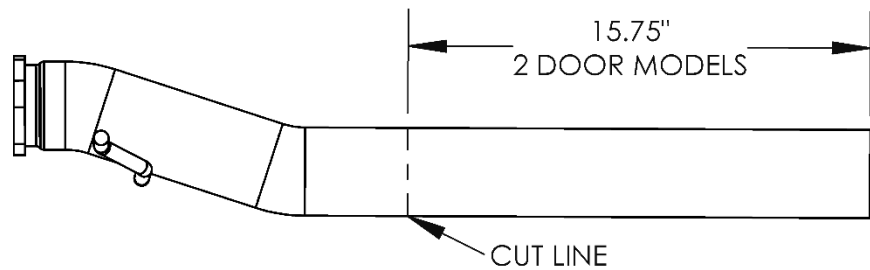

Figure 3

2. Slide the previously removed factory hanger bracket onto the **Front Pipe** hanger.

Refer to Figure 4.

3. Install the **Front Pipe** onto the factory flange using factory hardware and re-attach the hanger bracket. Do not tighten any components until the last step.

Refer to Figure 5. (4-Door shown)

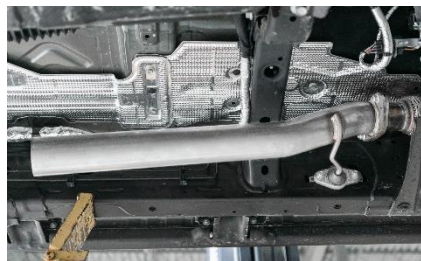

Figure 5

4. Install the **Mid-Pipe** onto the **Front Pipe** along with a **3.0" Clamp** and slide into the rubber isolator.

Refer to Figure 6.



Figure 6

MBRP



Figure 7

5. Place a **3.0” Clamp** onto the inlet of the **Over-Axle Pipe** and place onto the **Mid-Pipe**.

Refer to Figure 7.

6. Remove the drivers-side rear rubber isolator and slide onto the **Muffler Hanger**. Slide a **3.0” Clamp** onto the inlet of the **Muffler** and install onto the **Over-Axle Pipe** and attach the isolator back onto the vehicle.

Refer to Figure 8.



Figure 8

7. For 2.7L models skip to Step 8. For 2.3L models only, remove the passenger-side rubber isolator and slide it onto the **2.3L Hanger Bracket**. Place the **2.3L Spacer** over top of the factory passenger side hanger bracket as well as the **2.3L Hanger Bracket** securing with the 2- **M8 Flange Nuts**.

Refer to Figure 9.

8. Slide a **3.0” Clamp** onto the outlet of the **Muffler** and insert the **Tail Pipe** into the **Muffler** and rubber isolator.

Refer to Figure 10. (2.7L shown)



Figure 9

9. Align the edge of each band clamp with the edge of the joint it is connecting. Tighten all hardware and clamps, starting at the front and working rearward to secure the system. Confirm the 2 rearmost isolators are tilting into the center of the vehicle. Check along the full length of the exhaust system to ensure there is adequate clearance for fuel lines, vent lines, brake lines, frame, bodywork, suspension, and any wiring, etc. If there is any interference detected, relocate, or adjust to provide adequate clearance. Ensure all clamp connections are secure and components are unable to rotate or slide. Band clamps require approximately 45 lb-ft (60 N-m) of torque. Verify clearances, system security and band clamp torque after 30- 60 miles (50-100 km) of driving.



Figure 10



Congratulations! You are ready to begin experiencing the improved power, sound and driving experience of your **MBRP** performance exhaust system. We know you will enjoy your purchase.