

# S5128

2006-2008 RAM 1500,  
SINGLE/QUAD CAB SHORT BOX, 5.7L HEMI,  
Cat-Back, 3.0"/2.5", Dual Split Side

# MBRP®

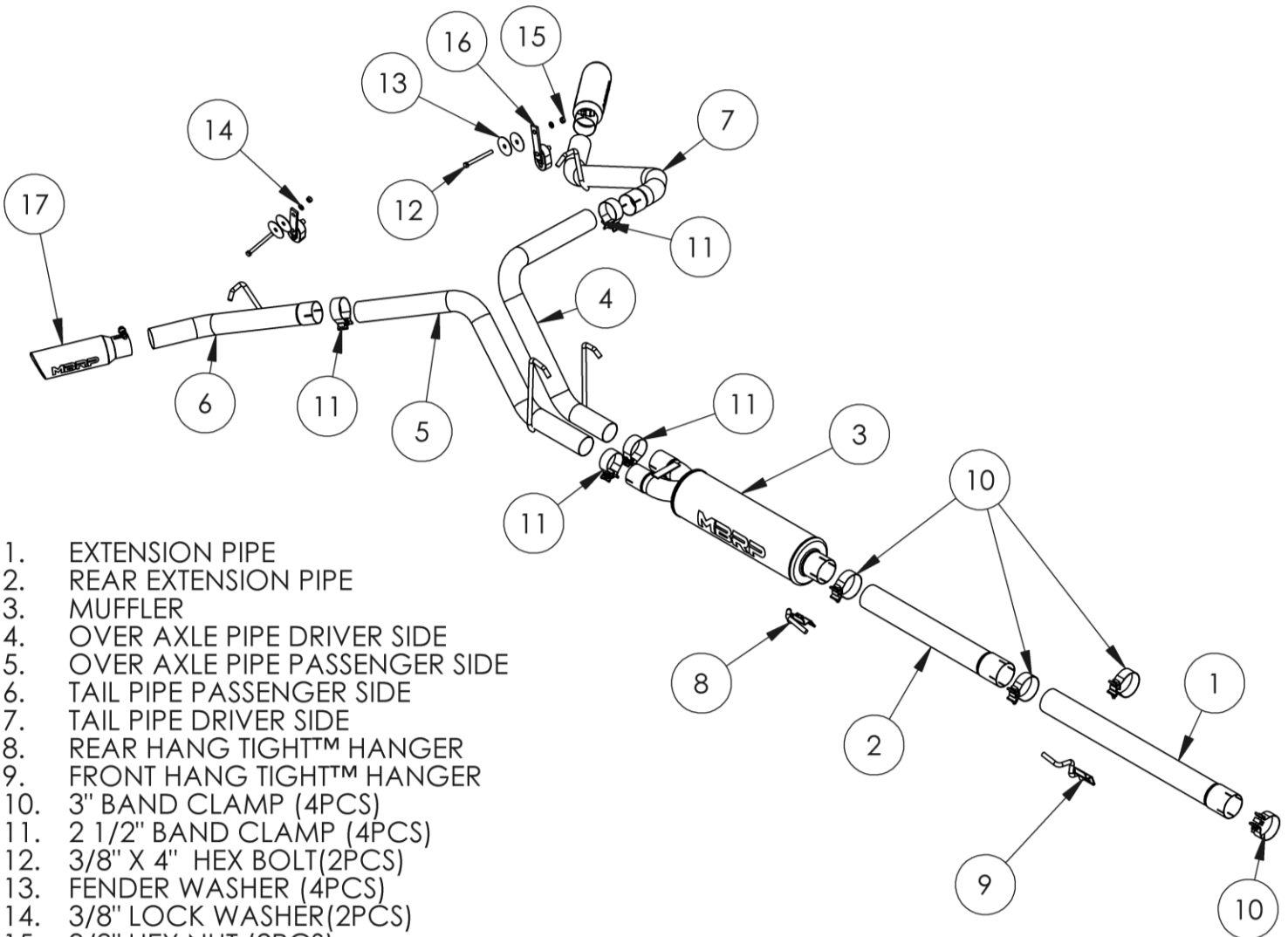

1. EXTENSION PIPE
2. REAR EXTENSION PIPE
3. MUFFLER
4. OVER AXLE PIPE DRIVER SIDE
5. OVER AXLE PIPE PASSENGER SIDE
6. TAIL PIPE PASSENGER SIDE
7. TAIL PIPE DRIVER SIDE
8. REAR HANG TIGHT™ HANGER
9. FRONT HANG TIGHT™ HANGER
10. 3" BAND CLAMP (4PCS)
11. 2 1/2" BAND CLAMP (4PCS)
12. 3/8" X 4" HEX BOLT(2PCS)
13. FENDER WASHER (4PCS)
14. 3/8" LOCK WASHER(2PCS)
15. 3/8" HEX NUT (2PCS)
16. HANGER ASSEMBLY (2PCS)
17. EXHAUST TIP(2PCS)

## PLEASE READ BEFORE STARTING INSTALLATION

**While MBRP has made every effort to ensure that all components of this system are of superior quality and properly packaged, it is the installer's responsibility to ensure the following before removal of the factory exhaust:**

- that ALL components shown above are present.
- that ALL mating components fit together.
- that there are no damaged components.
- that the system you have purchased is appropriate for your vehicle year, model and configuration.
- that the system will not interfere with any modifications previously installed or planned.
- that you have read and understand these instructions.

If you have any questions or are uncertain about any aspect of the installation of this system to your vehicle please contact your dealer before commencing installation.

# MBRP<sup>®</sup>

## 2006-2008 Dodge Ram 5.7L Hemi

### Removal of stock system:

1. Apply a penetrating lubricant liberally to all exhaust fasteners, hangers and rubber insulators.
2. Remove the clamp located behind the muffler. Remove the tail pipe hanger from the rubber insulator and separate the tail pipe from the muffler at the slip joint. Remove the tail pipe from the vehicle.
3. Remove the clamp in front of the muffler and separate the muffler at the slip joint.
4. Remove the hangers from the rubber insulators and remove the muffler assembly from the vehicle.

### Installation of MBRP Inc. Performance Exhaust:

- NOTES:** -This system does not require the removal of the spare tire.  
-Loosely attach clamp until last step

### Regular Cab Models

1. Temporarily install the **Passenger Side** and **Driver Side Over Axle Pipes** by placing hangers into the factory rubber insulators. Loosely install the **Muffler** onto the **Over Axle Pipes** with the **Driver Side Over Axle Pipe** connected to the muffler outlet closest to the drive shaft. Support the **Muffler** so that it is level with the vehicle. Now measure from the front of the **Muffler** to the "Y" pipe. This will give you the required length for the **Extension Pipe**. Remove the **Muffler** and **Over Axle Pipes**.
2. Cut the **Extension Pipe** to the required length (Regular cab short box remove rear extension pipe). Install the expanded end of the **Extension Pipe** over the factory exhaust system behind the "Y" pipe. Now install a **3" band clamp** with the **Front Hang Tight** (see **Figure 1** for hang tight installation instructions) onto the **Extension Pipe** to help support it.

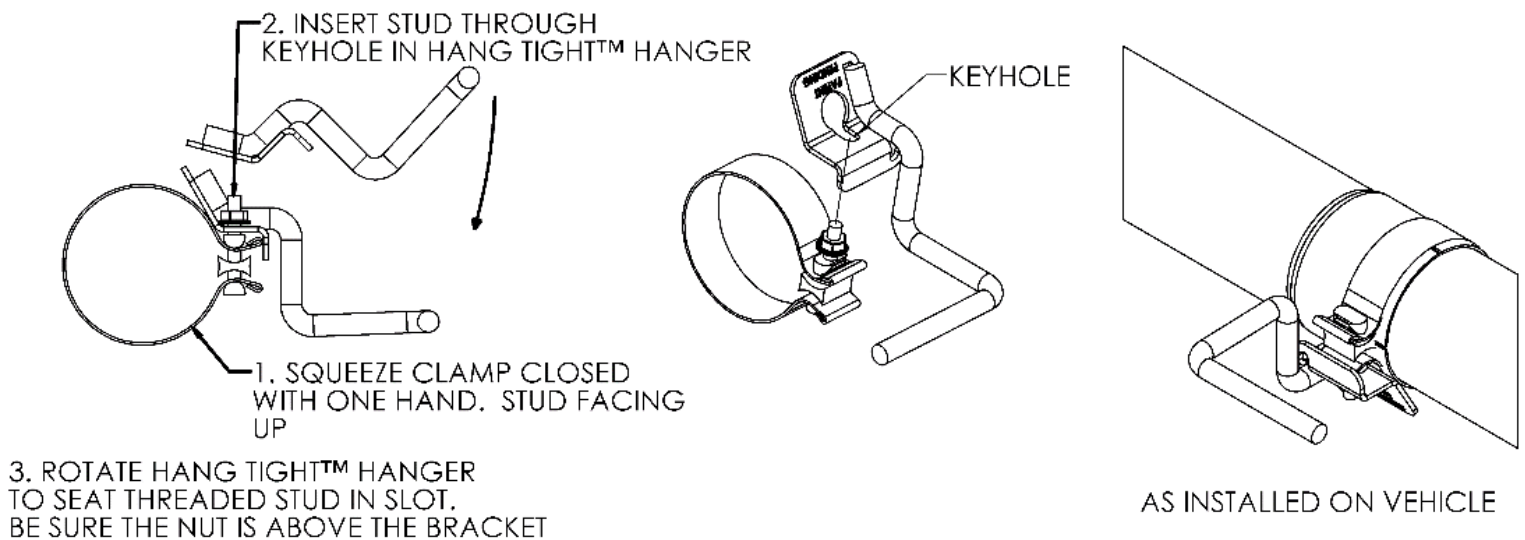

**Figure 1**

3. Skip to step 2 of **Quad Cab** Instructions.



## Quad Cab Models

1. Install the expanded end of the **Extension Pipe** over the factory exhaust system behind the "Y" pipe. Now install a **3" Band Clamp** with the **Front Hang Tight** (see **Figure 1** for hang tight installation instructions) onto the **Extension Pipe** to help support it.
2. Place the **Muffler** onto extension pipe along with a **3" Band Clamp** with the **Rear Hang Tight** installed.
3. Loosely connect the **Driver Side Over Axle Pipe** with a **2.5" Band Clamp** to the muffler outlet closest to the drive shaft and place the hanger into the rubber insulator.
4. Feed the **Passenger Side Over Axle Pipe** over the axle and connect it to the remaining muffler outlet with a **2.5" Band Clamp**. Now place the hanger into the rubber insulator.
5. Feed the expanded end of the **Driver Side Tail Pipe** with a **2.5" Band Clamp** from the rear of the vehicle over the axle and connect it to the **Driver Side Over Axle Pipe**.
6. Move the **Driver Side Tail Pipe** into approximate position. Using the factory hole provided in the frame located directly above the tail pipe hanger, attach the **Hanger Assembly** provided using the supplied hardware.
7. Remove the factory rubber insulator for the factory tail pipe. Now feed the expanded end of the **Passenger Side Tail Pipe** from the rear of the vehicle over the axle and loosely connect it to the **Passenger Side Over Axle Pipe** making sure to slide a **2.5" Band Clamp** along with it.
8. Move the **Passenger Side Tail Pipe** into approximate position. Using the factory hole provided in the frame located directly above the tail pipe hanger, attach the **Hanger Assembly** provided using the supplied hardware.
9. Install the **Mirror Polished Tips**. It is recommended to install them at this point to assist with the final system alignment.
10. Tighten all hardware and clamps, starting at the front and working rearward to secure the system. Check along the full length of the exhaust system to ensure there is adequate clearance for fuel lines, vent lines, brake lines, frame, bodywork, suspension, and any wiring, etc. If there is any interference detected, relocate, or adjust to provide adequate clearance. Ensure all clamp connections are secure and components are unable to rotate or slide. Band clamps require approximately 45 lb-ft (60 N-m) of torque. Verify clearances, system security and band clamp torque after 30-60 miles (50-100 km) of driving.

**Congratulations!** You are ready to begin enjoying the improved performance and driving experience of your MBRP Inc. Cool Duals system. We hope you enjoy your purchase.