

# Owner's Manual with Installation Instructions

## PowerPack® System Stinger® System

### **2005 & Later GM 8.1L Class-A W-24 Chassis Motorhomes**

THIS MANUAL IS FOR USE WITH SYSTEMS

49548, 49562, 49563, 49579 & 49580

Gale Banks Engineering  
546 Duggan Avenue • Azusa, CA 91702  
(626) 969-9600 • Fax (626) 334-1743

Product Information & Sales: (888) 635-4565

Customer Support: (888) 839-5600

Installation Support: (888) 839-2700

[bankspower.com](http://bankspower.com)

# General Installation Practices

Dear Customer,

If you have any questions concerning the installation of your Banks System, please call our Technical Service Hotline at (888) 839-2700 between 7:00 am and 5:00 pm (PT). If you have any questions relating to shipping or billing, please contact our Customer Service Department at (888) 839-5600.

Thank you.

**1.** For ease of installation of your Banks PowerPack system, familiarize yourself with the procedure by reading the entire manual before starting work. This manual contains 16 pages of copy, illustrations and parts listing. If any pages are missing from this manual please call Gale Banks Engineering immediately for a replacement.

**2.** The exploded view of the PowerPack assembly (page 4-5) provides only general guidance. Refer to each step and section diagram in this manual for proper instruction.

**3.** Throughout this manual, the leftside of the motorhomerefers to the driver's side, and the right-side to the passenger's side.

**4.** Banks Power systems are designed to fit Chevy 8.1L Workhorse Class-A motorhome chassis. Due to differences in coach layouts, it may be necessary to relocate or modify some coach or Banks system components to accommodate installation of the Banks Power system.

**5.** Disconnect the ground cable from the battery before beginning work. If there are two batteries, disconnect both.

**6.** Route and tie wires and hoses a minimum of 6 inches away from exhaust heat, moving parts and sharp edges. Clearance of 8 inches or more is recommended where possible.

**7.** During installation, keep the work area clean. If foreign debris is transferred to any Banks system component, clean it thoroughly before installing.

*NOTE: If installing the Stinger system proceed to Step 21.*

**8.** The front of your motorhome should be raised a minimum of 5-6 inches to allow the installation of Banks TorqueTube® exhaust manifolds. If you have access to a hoist, the motorhomecan be elevated and the front wheels removed for easiest access.

**9.** When raising the vehicle, support it on properly weight-rated safety stands, ramps or a commercial hoist. Follow the manufacturer's safety precautions. Take care to balance the motorhome to prevent it from slipping or falling. When using ramps, be sure the front wheels are centered squarely on the topsides; put the transmission in park; set the hand brake; and place blocks behind the rear wheels.

**CAUTION! Do not use floor jacks to support the motorhomewhile working under it. Do not raise the motorhomeonto concrete blocks, masonry or any other item not intended specifically for this use.**

**NOTIFICATION! The Banks Ram-Air Filter comes pre-oiled and no oiling is necessary for initial installation. Service the Ram-Air filter as specified in the Cleaning and Oiling the Banks Ram-Air Filter Section of this manual.**

# Installation Instructions

**1.** With the motorhome safely raised, ground wire(s) disconnected, and precautions in place, remove the factory exhaust system.

**2.** To provide better access to the manifolds remove the front wheels from the motorhome. If the motorhome is equipped with inner front fender shields, remove them for improved access.

*NOTE: Before removing the lug nuts, make sure a capable torque wrench is available to tighten the lug nuts to the manufacturer's torque specifications*

**3.** Locate the oxygen sensors in the exhaust headpipes on each side of the engine, forward of the catalytic converters. Unplug the connectors and unscrew the oxygen sensors, keeping track of the left and right sensors. Be careful not to touch or contaminate the sensor.

**4.** Remove the factory hardware on the front 2-bolt headpipe flanges. Remove the hardware on 3-bolt flanges on the exhaust manifolds / headpipe assemblies. Remove the headpipes from the exhaust manifolds.

*NOTE: Whenever possible, it is recommended that the catalytic converters be inspected. Restricted or damaged catalytic converters can impede performance of your Banks PowerPack.*

**5.** Remove the engine oil dipstick by unbolting the bracket from the alternator support and the engine block (see **Figure 2**). Remove the dipstick and dipstick tube by pulling and twisting upward. If the dipstick tube o-ring is stuck inside the hole in the engine block, remove it and place it back onto the dipstick tube. Retain all hardware for reassembly.

**6.** Remove the spark-plug wires and the spark plugs from both sides of the

engine. Note their original locations so they can be properly reinstalled.

**7.** Remove the nuts holding the spark-plug wire heatshields to the exhaust manifold studs. Remove the heatshields.

**8.** With a wrench or socket, back the exhaust manifold nuts at least one turn away from the manifolds. Use a #7 female torx socket to unscrew each stud from the head. If this tool is not available use a 7/32 socket. Take out the studs so the exhaust manifolds can be removed.

**9. CAUTION: Make sure all ground cables are removed from vehicle's battery(s).**

Remove the starter wire battery cable from the starter motor. Remove the factory starter cable from the starter and install the 90-degree terminal end of the supplied starter extension cable (red) onto the starter motor and tighten the retaining nut. Remove the factory ground cable from the starter and install the supplied ground extension cable (black) to the starter.

**10.** Route the starter extension cables (red & black) forward under the motor mount. Attach a supplied heat wrap to the extension cables. Zip-tie the extension cables and heat wrap to the factory motorhome wire harness. Route the extension cables inside the frame rail (see **Figure 3**).

**11.** Slide the 4-inch length of heat shrink over the extension cables, such that the red heat shrink is on the red cable and black heat shrink on black cable. Attach the extension to the correct factory starter cable using (1) 5/16-18 x 1/2" bolt, (1) 5/16-18 crimplock nut, and (1) 5/16 washer per cable. Slide the heat shrink over the connection and heat with a heat gun until the heat shrink tightly conforms to the connection. Make sure the connection is completely covered.

# General Assembly

**Figure 1**

Item#	Description	Qty	P/N
1	TorqueTube, Driver Side	1	53691
2	TorqueTube, Pass Side	1	53692
3	Conical Seal	2	93161
4	Head Pipe, Driver Side	1	53693
5	Head Pipe, Pass Side	1	53694
6	Knock Sensor Heatshield	1	26125
7	Heat Shield Blanket (6"x7")	2	26000
8	Heat Shield Blanket (3"x16")	2	26004
9	Cable Ties	16	26013
10	Ground Cable Extension	1	62181
11	Starter Cable Extension	1	62180
12	2-Bolt Gasket	4	93702
13	Air filter	1	41022
14	Crossover Pipe	1	53655
15	Muffler Inlet	1	53656
16	Dynaflow Muffler	1	53685
17	Upper Tailpipe (D/S)	1	53661
18	Lower Tailpipe Extension (D/S)	1	53661
19	Tailpipe Tip	1	52384
20	Frame Mount Muffler Hanger	1	53657
21	Frame Mount Tailpipe Hanger (D/S)	1	53659
22	Universal Exhaust Hanger	1	52193
23	Upper Tailpipe (P/S)	1	53663
24	Lower Tailpipe Extension (P/S)	1	53664
25	Frame Mount Tailpipe Hanger (P/S)	1	53662

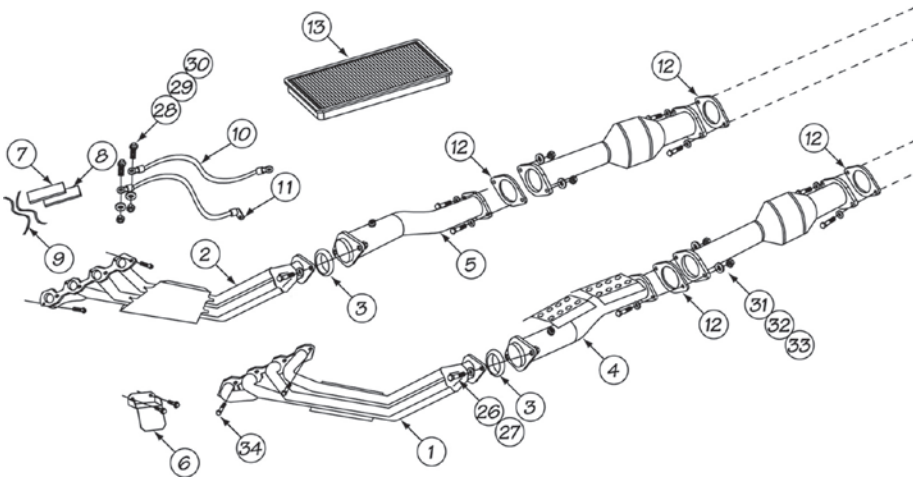

Item#	Description	Qty	P/N
26	3/8"-16 x 1.75" Bolt	4	91430
27	3/8" Washer, SAE Flat	4	91402
28	5/16-24 x 1/2" Bolt	2	91250
29	5/16" Washer, SAE Flat	2	91201
30	5/16"-24 Nut, Flexlock	2	91217
31	7/16"-20 x 1.5" Bolt	8	91629
32	7/16" Washer, SAE Flat	16	91602
33	7/16"-20 Nut, CrimpLock	8	91619
34	8mm-1.25 x 25mm Bolt	19	91809
35	3/8-16 Nut, Crimplock	1	91416
36	12mm X 1.75X 40, Bolt	2	91870
37	12mm X 1.75 X 40, Nut	2	91871
38	1/2" Washer, SAE Flat	4	91902

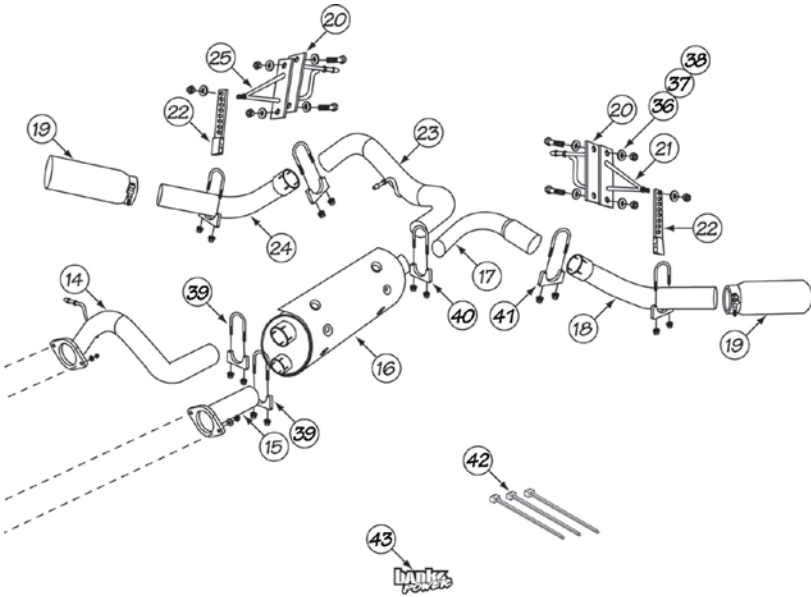

Item#	Description	Qty	P/N
39	Exhaust Clamp, 3"	2	52465
40	Exhaust Clamp, 3.5"	1	52468
41	Exhaust Clamp, 4"	2	52476
42	Cable Ties, 11"	10	62002
43	Banks, Urocal	3	96010

**Figure 2**

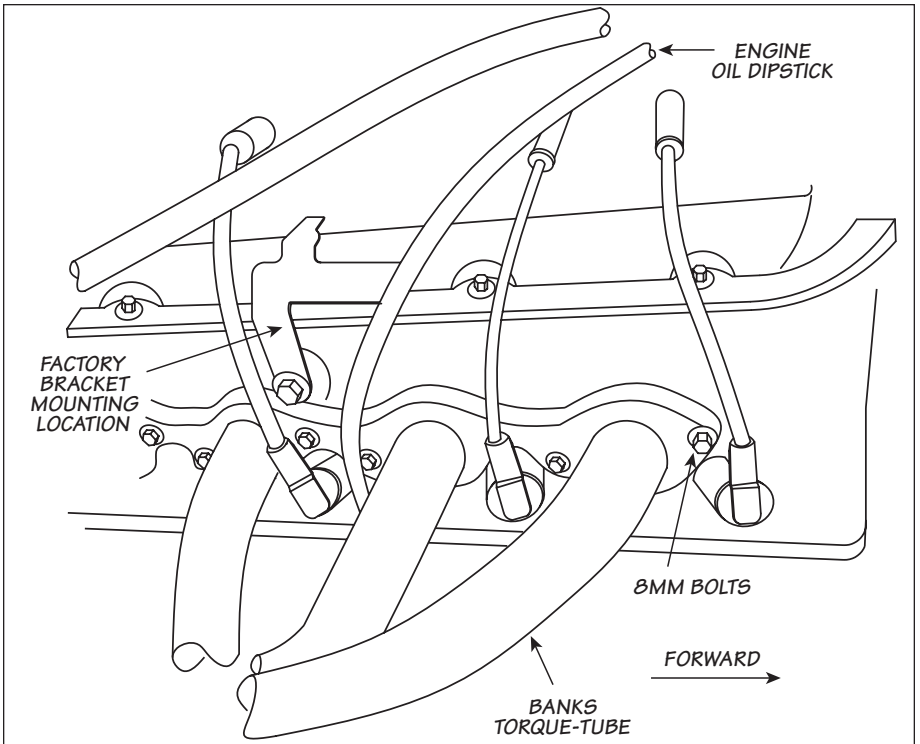

**12.** Inspect the exhaust mounting surfaces of the cylinder heads and remove any rust or carbon, which would prevent the TorqueTube manifolds from sealing. Zip-tie cables away from left-side Torque Tube as shown in **Figure 4**.

*NOTE: Do not use the factory exhaust manifold gaskets upon reinstallation. Banks TorqueTubes have a machined surface and are designed to seal without gaskets.*

**13.** On the left engine block, remove the factory knock sensor heatshield located just below the exhaust ports next to the oil filter. Install the Banks knock sensor heatshield to the factory using the factory hardware (see **Figure 5**).

**14.** Apply a small amount of antiseize on the threads of the supplied 8 mm manifold bolts. Lift the right side TorqueTube manifold into place and install one 8 mm bolt at the front and rear of the TorqueTube to hold in place. Install the remaining 8 mm manifold bolts to secure the TorqueTube. Repeat this step for the left side TorqueTube. Reinstall the dipstick tube and o-ring. Reattach the bracket to the engine block as shown in **Figure 2**.

**15.** Re-secure the bracket to the alternator support using the bolt previously removed. Re-install the spark plug wires in their original locations. Torque all manifold bolts to 26 ft-lbs.

**Figure 3**

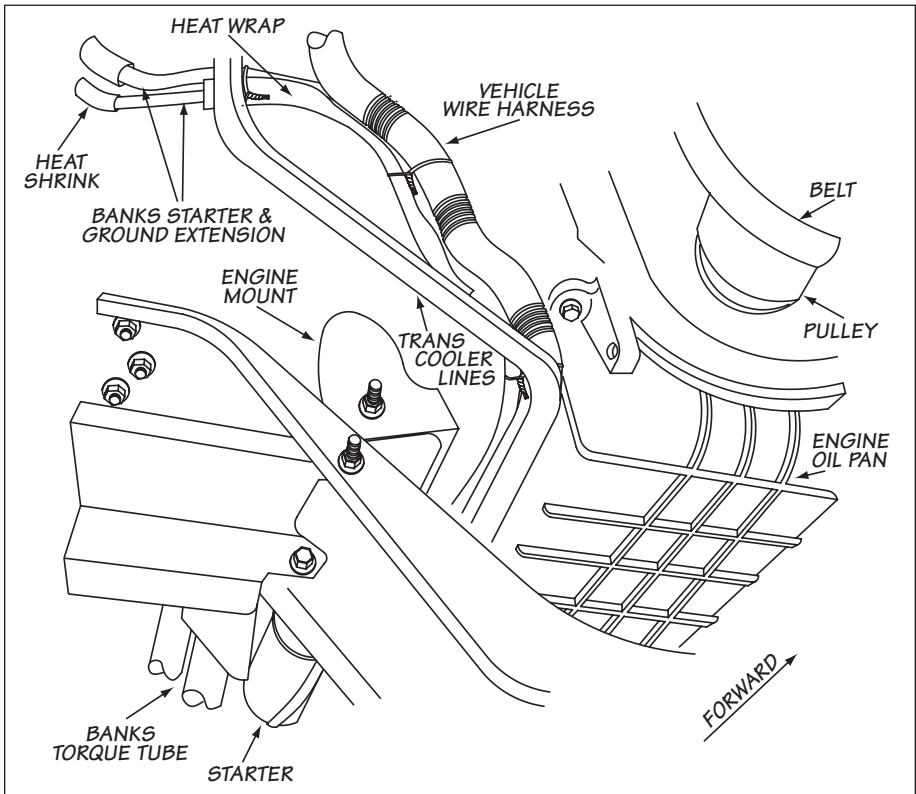

**16.** Place a conical seal in the flare on the Banks right side headpipe. Attach the headpipe to the right-side TorqueTube manifold using (2)  $\frac{3}{8}$ -16 x 1  $\frac{3}{4}$ -inch bolts and (2)  $\frac{3}{8}$  SAE washers provided. Tighten the bolts just enough to hold the headpipe in place. Repeat for left side headpipe.

**17.** Insert the 2-bolt gasket onto the rear of right side headpipe. Attach the rear of the headpipe and 2-bolt flange to the catalytic converter inlet. Connect using (2)  $\frac{7}{16}$ -20 x 1  $\frac{1}{2}$ " bolts, (2) crimplock nuts, and (4)  $\frac{7}{16}$  SAE washers. Repeat for left side headpipe.

**18.** Tighten the bolts on the 2-bolt flange on the back of the head pipe, then at the front. Torque  $\frac{7}{16}$ " Hardware to 48 ft-lbs.

**19.** Apply a small amount of antiseize to the threads of the oxygen sensors previously removed.

**CAUTION: Make sure no anti-seize gets on the tip of the oxygen sensor. This will damage the sensor.**

Install the oxygen sensors in the headpipe making sure they are in their original locations. Zip ties may need to be removed and new zip ties added to properly position the oxygen sensor cables.

**Figure 4**

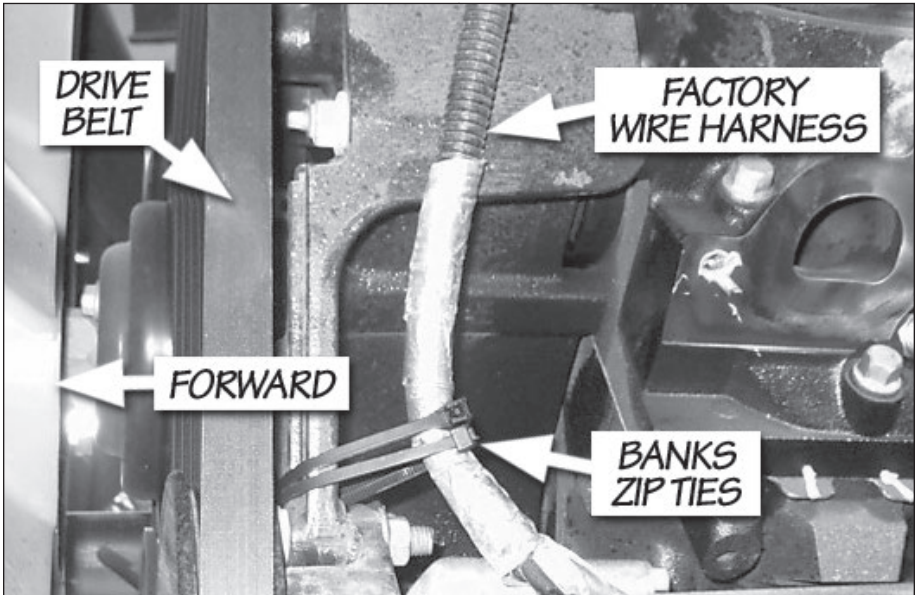

**Figure 5**

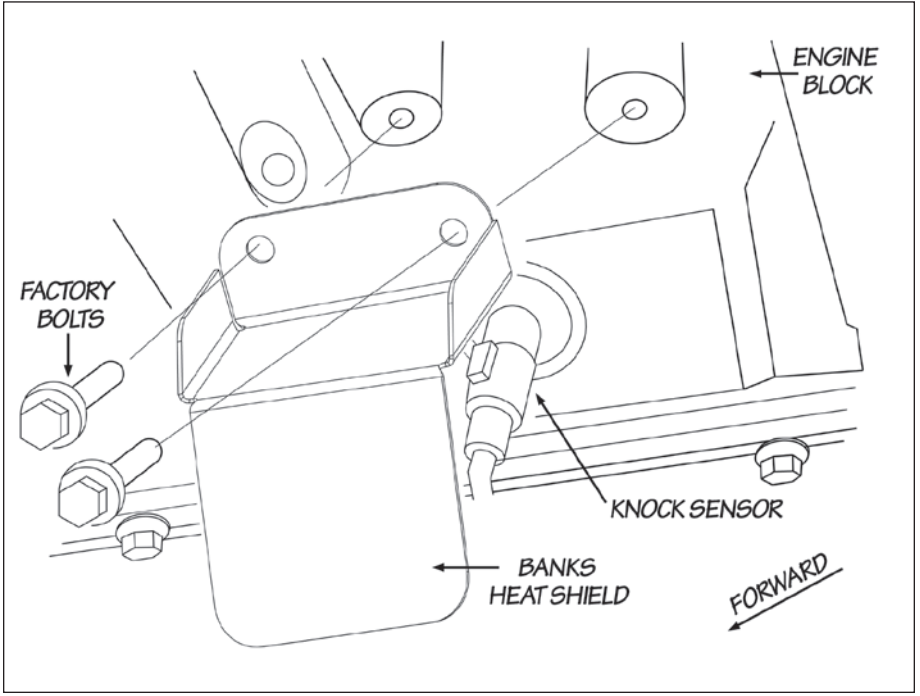



**20.** Remove the 2-factory heatshields and 4-factory 3" clamps from the factory left-side headpipe. Install the factory heatshield onto the Banks left-side headpipe. Adjust the heatshields and clamps such that the ABS module and Aren shifter is protected (see **Figure 6**).

**21.** To remove the factory tailpipes and mufflers, unbolt the 2-bolt flanges at the front of each muffler (see **Figure 7**). Remove the muffler and tailpipe hanger pins from the motorhome's rubber grommets. Remove the factory muffler & tailpipe assemblies.

**22.** Insert the crossover pipe hanger into the rubber hanger previously used for the front hanger on the right-side muffler. Using the  $\frac{7}{16}$ " hardware, and supplied 2-bolt gasket, bolt the 2-bolt crossover pipe flange to the catalytic converter outlet intermediate pipe.

**23.** Install the muffler inlet pipe and 2-bolt gasket onto the left catalytic converter outlet intermediate pipe. Attach using the  $\frac{7}{16}$ " hardware.

**24.** Install the Banks muffler hanger bracket (with barbed pin) inside of the frame rail using the (2) M12-1.75x40mm bolts through the two holes in the frame rail approximately

**Figure 6**

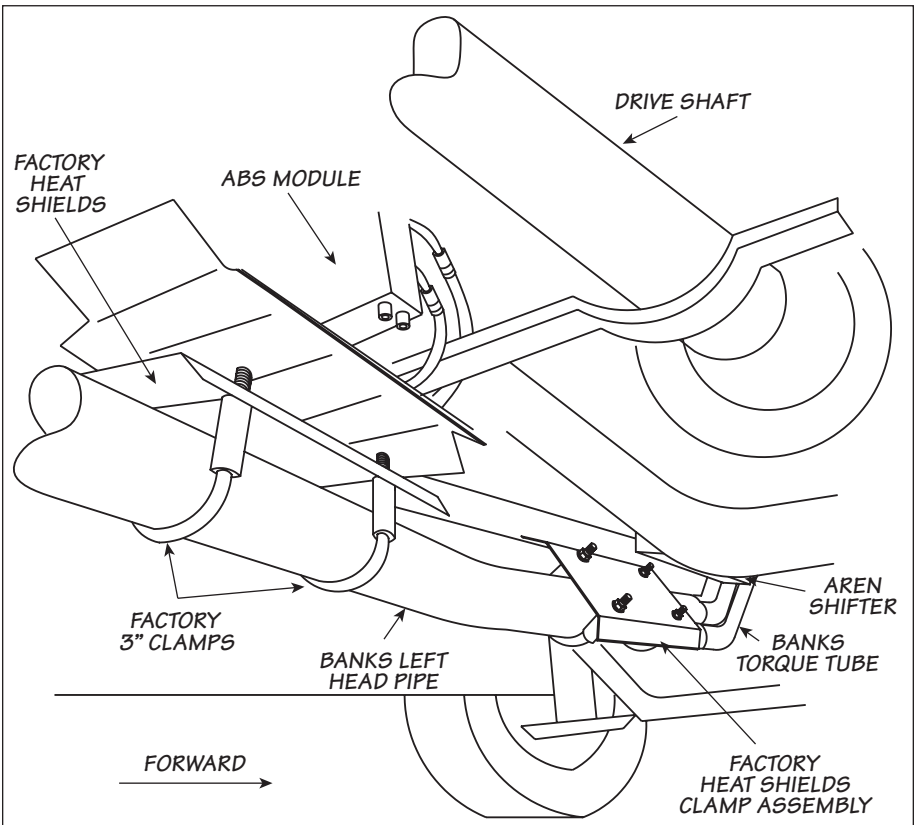

**Figure 7**

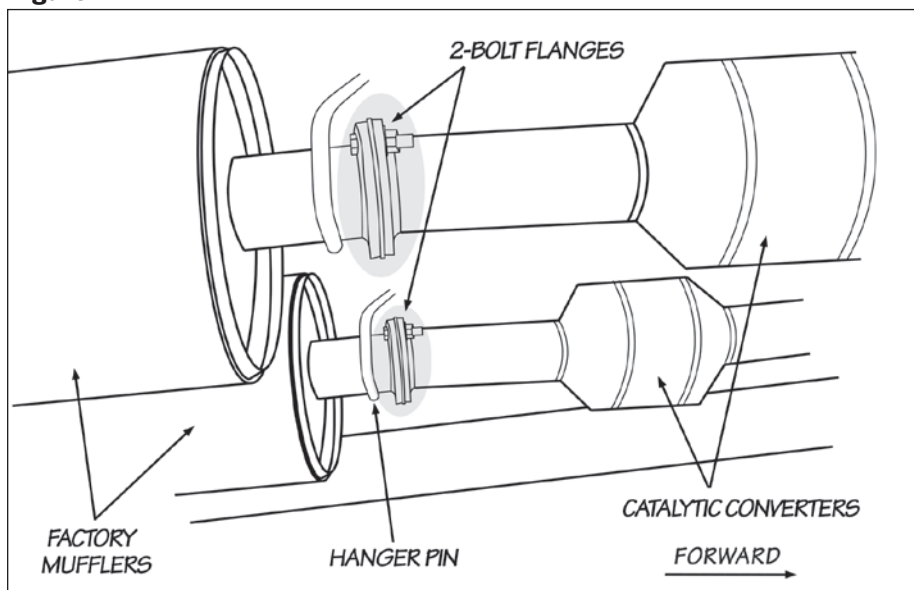

3 inches in front of the frame cross member (see **Figure 8**). For right exit systems, tighten the M12 hardware.

**25. For left exit exhaust systems:**

Install the Banks tailpipe hanger bracket (with stud) outside of the left frame rail using the same M12 bolts as for the inside hanger bracket. Tighten the supplied M12 hardware. Remove the factory muffler rubber hanger and install it on the Banks hanger bracket.

**26.** Slide a 3-inch clamp onto the crossover pipe and muffler inlet pipe. With the muffler heat-shielded portion facing the frame rail, insert the muffler hanger into the rubber hanger. Make sure the two inlets to the muffler are vertical. Install the muffler inlets onto the Banks inlet and crossover pipes. Make sure the muffler is fully seated and tighten the 3-inch clamps. Slide a 3½" clamp onto the muffler outlet.

**27. For right exit exhaust systems:**

Remove the factory right-side frame

mounted hanger used to support muffler. Reinstall the factory hanger bracket inside of the frame rail through the holes approximately 3 inches in front of the frame cross member. Install the Banks tailpipe hanger bracket (with stud) outside the right frame rail using the same inside factory hanger studs and hardware. Tighten the factory nuts.

**28.** Install the upper tailpipe into the muffler outlet. For right side exits, route the tailpipe over the drive shaft and hanger into the relocated rubber hanger.

**29.** Slide the lower tailpipe extension onto the installed upper tailpipe. Level the tailpipe extension to the vehicle. The tailpipe extension should be 1 to 2 inches below the bottom of the motorhome body. If the pipe is more than 2 inches below the body, remove and trim the upper tailpipe to raise the tailpipe extension. Make sure to trim the upper tailpipe and not the lower tailpipe extension. Also, be sure to

**Figure 8 (Driver-side shown)**

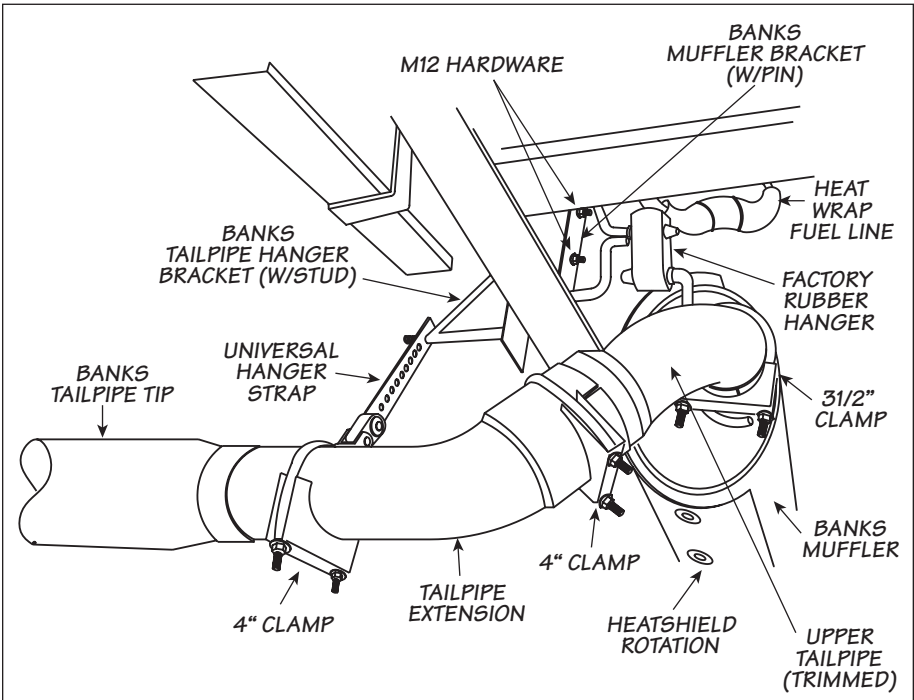

leave at least 3.5 inches of straight on the tailpipe at the slip joint so it can be correctly inserted into the slip of the extension.

**30.** With the proper height established, install the 4-inch clamp over the tailpipe extension slip joint and snug up the clamp. Do not tighten completely at this time incase more adjustment is required.

**31.** Level the tailpipe extension with the motorhome and place the 4-inch universal hanger strap onto the extension pipe. Insert one of the hanger strap holes into the Banks tailpipe hanger bracket stud. Using the  $\frac{3}{8}$ " SAE washer and crimplock nut provided secure the hanger strap to the frame mounted hanger. Slide the 4-inch hanger clamp on the extension pipe until the hanger strap is square to

the extension pipe. Lightly tighten the clamp (See **Figure 8**).

**32.** Check the extension pipe to ensure it is level and the gap between it and the body is correct. If not loosen the connections and adjust accordingly. Once pipe is level and at the correct height tighten all clamps. Install a  $3\frac{1}{2}$ " clamp on the outlet of the muffler. Make sure the tailpipe is inserted fully into the slip joint of the muffler and tighten the clamp.

**33.** Wrap the factory rubber fuel line above the muffler with the supplied heat wrap and retain with steel cable ties

**34.** Slide the tailpipe tip onto the tailpipe extension. Position the tip so it extends 1-inch beyond the coach body or wherever aesthetically pleasing and tighten the band-clamp.

# Cleaning and Oiling the Banks Ram-Air Filter

**NOTIFICATION!** The Banks Ram-Air Filter comes pre-oiled and no oiling is necessary for initial installation. Use Banks Ram-Air Filter cleaning system (part#90094), available from Gale Banks Engineering to service the Air Filter. Follow the instructions included with the cleaning system to clean and re-oil your Banks Ram-Air Filter.

## 1. PRE-CLEANING

Tap the element to dislodge any large embedded dirt, then gently brush with a soft bristle brush.

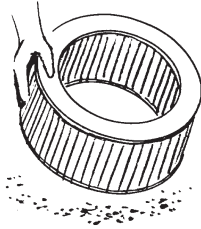

*NOTE: If complete cleaning is not practical at this time, reoil the element and reinstall in your vehicle.*

## 2. SPRAY-ON CLEANING

Spray air-filter cleaner liberally onto the entire element and let soak for 10 minutes.

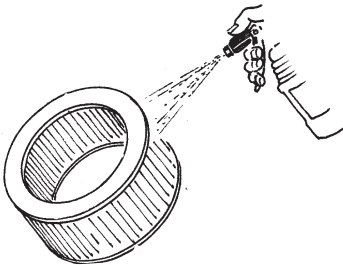

## PAN CLEANING

Large air-filter elements can be rolled or soaked in a shallow pan of air-filter cleaner. Remove immediately and let soak for approximately 10 minutes.

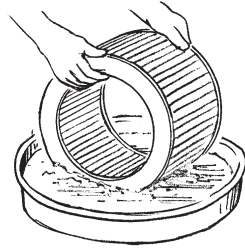

## 3. CLEANING HINTS

Use only air-filter cleaner. No gasoline cleaning, No steam cleaning, No caustic cleaning solutions, No strong detergents, No high-pressure car wash, No parts cleaning solvents. Any of these Nos can cause harm to the cotton filter media plus SHRINK and HARDEN the rubber end caps.

## 4. RINSE OFF

Rinse off the element with low-pressure water. Tap water is okay. Always flush from the clean side to dirty side. This removes the dirt and does not drive it into the filter.

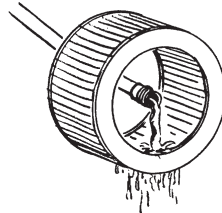

## 5. DRYING HINTS

Always dry naturally. After rinsing, shake off all excess water and let the element dry naturally.

**DO NOT USE COMPRESSED AIR – DO NOT USE OPEN FLAME – DO NOT USE HEAT DRYERS!**

**EXCESS HEAT WILL SHRINK THE COTTON FILTER MEDIA. COMPRESSED AIR WILL BLOW HOLES IN THE ELEMENT.**

## 6. AEROSOL OILING

After cleaning air filter always reoil before using. Spray Banks Ram-Air filter oil down into each pleat with one pass per pleat. Wait 10 minutes and re-oil any white spots still showing.

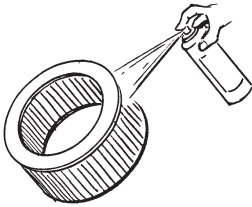

## 7. OILING HINTS

Never use a Banks Ram-Air filter without oil (the filter will not stop the dirt without the oil). Use only air filter oil. Air-filter oil is a compound of mineral and animal oil blended with special polymers to form a very efficient tack barrier. Red dye is added to show just where you have applied the oil. Eventually the red color will fade but the oil will remain and filter the air. NEVER USE Automatic Transmission Fluid. NEVER USE Motor Oil. NEVER USE Diesel Fuel. NEVER USE WD40, LPS, or other light-weight oils.

## 8. REINSTALL

Reinstall your Banks Ram-Air filter element with proper care. Make sure the element seats properly in the filter case. Install the cover making sure it's in the right position. Tighten all the nuts, bolts, screws or clips to factory specifications.

## 9. DO NOT DISCARD

Affix the "Do Not Discard" sticker to the filter case (included with every Banks replacement element). Make sure you put the sticker in a highly visible place to alert your mechanic not to discard.

## 10. PERFORMANCE HINTS

Service every 50-100,000 miles on street-driven applications. Service more often in offroad or heavy-dust conditions. If an air-filter restriction gauge is installed, then change the element when the air-filter restriction reaches 18"/H.O.

**CAUTION! Extremely fine dust from agriculture or offroad use will pull the oil from the element. Frequent reoiling of the element's clean side might be required. Completely service when practicable. For extra protection use an air-filter sealing grease on rubber ends of the element. Service only with air-filter cleaner and air-filter oil.**

# Notes

# Notes

Gale Banks Engineering  
546 Duggan Avenue • Azusa, CA 91702  
(626) 969-9600 • Fax (626) 334-1743

Product Information & Sales: (888) 635-4565  
Customer Support: (888) 839-5600  
Installation Support: (888) 839-2700

**bankspower.com**